

NTPULT-R – Replacing the battery.

20-04-2017 - Version. 1.

1. Replacing the battery.

This document describes how to replace the battery in the NTPULT-R control panel.

1.1 Instructions.

1. Unscrew the 4 screws on the left side of the control panel and remove the bracket.



2. Gently pull the front of the control panel halfway out of the frame, until the battery is fully visible.



3. Disconnect the battery connector and remove the 4 screws retaining the battery.
4. Install the new battery and reassemble in reverse order.

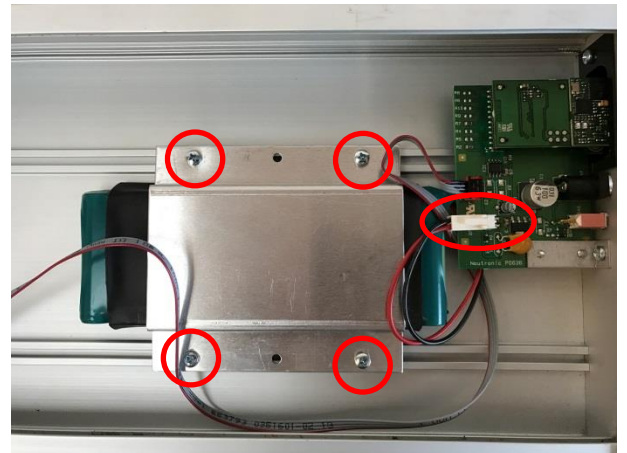

Please don't hesitate to contact us if you have any questions